

地積測量図 縮尺 1:400

所在 高岡市四屋、横田 地内

令和 3年11月24日 測量

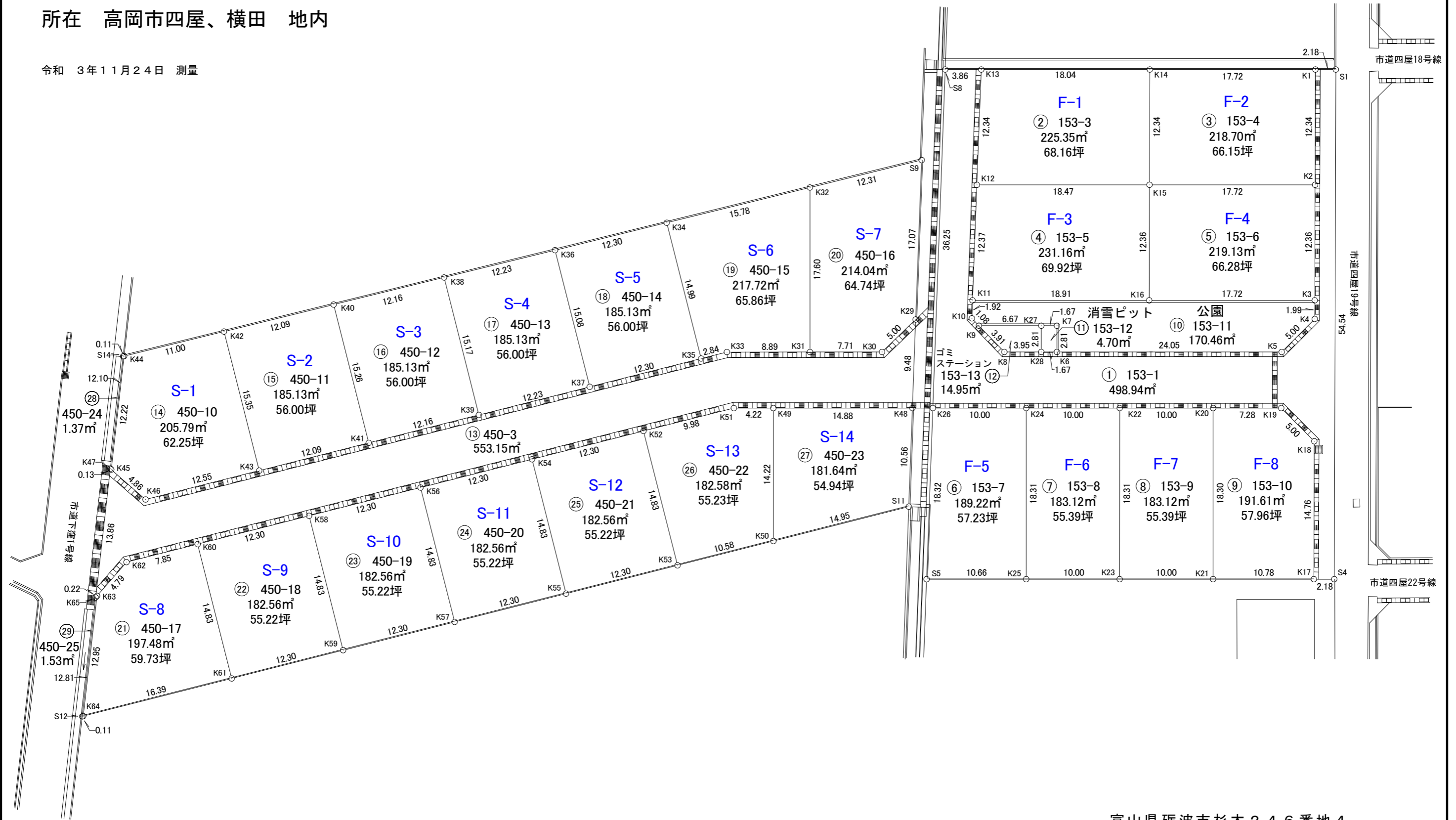
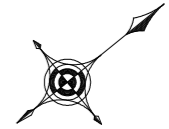

富山県砺波市杉木246番地4
土地家屋調査士 吉森 茂

求積表

地番	① 153-1				
NO	Xn	Yn	Yn+1-Yn-1	Xn · (Yn+1-Yn-1)	
S1	84519.617	-14878.828	-43.662	-3690295.517454	
K1	84517.916	-14880.207	8.191	692286.249956	
K2	84510.124	-14870.637	19.159	1619129.465716	
K3	84502.316	-14861.048	11.133	940764.284028	
K4	84501.060	-14859.504	2.064	174410.187840	
K5	84496.086	-14858.984	-14.621	-1235417.273406	
K6	84477.392	-14874.125	-16.193	-1367942.408656	
K28	84476.093	-14875.177	-3.539	-298960.893127	
K8	84473.021	-14877.664	-6.391	-539867.077211	
K9	84472.674	-14881.568	-4.987	-421265.225238	
K10	84472.577	-14882.651	-2.533	-213969.037541	
K11	84473.845	-14884.101	-10.765	-909360.941425	
K12	84481.990	-14893.416	-18.612	-1572378.797880	
K13	84490.119	-14902.713	-11.728	-990900.115632	
S8	84487.117	-14905.144	24.895	2103306.777715	
K26	84463.293	-14877.818	33.621	2839740.373953	
K24	84471.064	-14871.523	12.590	1063490.695760	
K22	84478.835	-14865.228	12.590	1063588.532650	
K20	84486.607	-14858.933	10.883	919467.743981	
K19	84492.272	-14854.345	9.567	808337.566224	
K18	84492.789	-14849.366	16.424	1387709.566536	
K17	84483.463	-14837.921	12.821	1083162.479123	
S4	84485.162	-14836.545	-40.907	-3456034.521934	
				合計	-997.886022
				合計面積	498.9430110
				地積	498.94 ㎡

地番	② 153-3				
NO	Xn	Yn	Yn+1-Yn-1	Xn · (Yn+1-Yn-1)	
K13	84490.119	-14902.713	-2.057	-173796.174783	
K12	84481.990	-14893.416	20.924	1767701.158760	
K15	84496.351	-14881.789	2.057	173808.994007	
K14	84504.143	-14891.359	-20.924	-1768164.688132	
				合計	-450.710148
				合計面積	225.3550740
				地積	225.35 ㎡

地番	③ 153-4				
NO	Xn	Yn	Yn+1-Yn-1	Xn · (Yn+1-Yn-1)	
K14	84504.143	-14891.359	-1.582	-133685.554226	
K15	84496.351	-14881.789	20.722	1750933.385422	
K2	84510.124	-14870.637	1.582	133695.016168	
K1	84517.916	-14880.207	-20.722	-1751380.255352	
				合計	-437.407988
				合計面積	218.7039940
				地積	218.70 ㎡

地番	④ 153-5				
NO	Xn	Yn	Yn+1-Yn-1	Xn · (Yn+1-Yn-1)	
K15	84496.351	-14881.789	21.216	1792674.582816	
K16	84488.544	-14872.200	-2.312	-195337.513728	
K11	84473.845	-14884.101	-21.216	-1792197.095520	
K12	84481.990	-14893.416	2.312	195322.360880	
				合計	462.334448
				合計面積	231.1672240
				地積	231.16 ㎡

地番	⑤ 153-6				
NO	Xn	Yn	Yn+1-Yn-1	Xn · (Yn+1-Yn-1)	
K15	84496.351	-14881.789	1.563	132067.796613	
K2	84510.124	-14870.637	20.741	1752824.481884	
K3	84502.316	-14861.048	-1.563	-132077.119908	
K16	84488.544	-14872.200	-20.741	-1752376.891104	
				合計	438.267485
				合計面積	219.1337425
				地積	219.13 ㎡

地番	⑥ 153-7				
NO	Xn	Yn	Yn+1-Yn-1	Xn · (Yn+1-Yn-1)	
K26	84463.293	-14877.818	7.518	634995.036774	
S5	84451.250	-14864.005	20.525	1733361.906250	
K25	84459.538	-14857.293	-7.518	-634966.806684	
K24	84471.064	-14871.523	-20.525	-1733768.588600	
				合計	-378.452260
				合計面積	189.2261300
				地積	189.22 ㎡

地番	⑦ 153-8				
NO	Xn	Yn	Yn+1-Yn-1	Xn · (Yn+1-Yn-1)	
K24	84471.064	-14871.523	7.935	670277.892840	
K25	84459.538	-14857.293	20.523	1733363.098374	
K23	84467.310	-14851.000	-7.935	-670248.104850	
K22	84478.835	-14865.228	-20.523	-1733759.130705	
				合計	-366.244341
				合計面積	183.1221705
				地積	183.12 ㎡

地番	⑧ 153-9				
NO	Xn	Yn	Yn+1-Yn-1	Xn · (Yn+1-Yn-1)	
K22	84478.835	-14865.228	7.933	670170.598055	
K23	84467.310	-14851.000	20.522	1733438.135820	
K21	84475.083	-14844.706	-7.933	-670140.833439	
K20	84486.607	-14858.933	-20.522	-1733834.148854	
				合計	-366.248418
				合計面積	183.1242090
				地積	183.12 ㎡

地番	⑨ 153-10				
NO	Xn	Yn	Yn+1-Yn-1	Xn · (Yn+1-Yn-1)	
K20	84486.607	-14858.933	9.639	814366.404873	
K21	84475.083	-14844.706	21.012	1774990.443996	
K17	84483.463	-14837.921	-4.660	-393692.937580	
K18	84492.789	-14849.366	-16.424	-1387709.566536	
K19	84492.272	-14854.345	-9.567	-808337.566224	
				合計	-383.221471
				合計面積	191.6107355
				地積	191.61 ㎡

地番	⑩ 153-11				
NO	Xn	Yn	Yn+1-Yn-1	Xn · (Yn+1-Yn-1)	
K3	84502.316	-14861.048	12.696	1072841.403936	
K4	84501.060	-14859.504	2.064	174410.187840	
K5	84496.086	-14858.984	-14.621	-1235417.273406	
K6	84477.392	-14874.125	-17.328	-1463824.248576	
K7	84479.160	-14876.312	-3.239	-273627.999240	
K27	84477.862	-14877.364	-5.256	-444015.642672	
K9	84472.674	-14881.568	-5.287	-446607.027438	
K10	84472.577	-14882.651	-2.533	-213969.037541	
K11	84473.845	-14884.101	10.451	882836.154095	
K16	84488.544	-14872.200	23.053	1947714.404832	
				合計	340.921830
				合計面積	170.4609150
				地積	170.46 ㎡

地番	⑪ 153-12				
NO	Xn	Yn	Yn+1-Yn-1	Xn · (Yn+1-Yn-1)	
K7	84479.160	-14876.312	3.239	273627.999240	
K6	84477.392	-14874.125	1.135	95881.839920	
K28	84476.093	-14875.177	-3.239	-273618.065227	
K27	84477.862	-14877.364	-1.135	-95882.373370	
				合計	9.400563
				合計面積	4.7002815
				地積	4.70 ㎡

地番	⑫ 153-13				
NO	Xn	Yn	Yn+1-Yn-1	Xn · (Yn+1-Yn-1)	
K28	84476.093	-14875.177	-0.300	-25342.827900	
K8	84473.021	-14877.664	-6.391	-539867.077211	
K9	84472.674	-14881.568	0.300	25341.802200	
K27	84477.862	-14877.364	6.391	539898.016042	
				合計	29.913131
				合計面積	14.9565655
				地積	14.95 ㎡

地番	⑬ 450-3				
NO	Xn	Yn	Yn+1-Yn-1	Xn · (Yn+1-Yn-1)	
K29	84467.828	-14886.339	6.710	566779.125880	
K48	84461.596	-14879.191	-2.214	-186997.973544	
K49	84450.027	-14888.553	-12.021	-1015173.774567	
K51	84446.741	-14891.212	-6.840	-577615.708440	
K52	84437.679	-14895.393	-9.338	-788479.046502	
K54	84426.503	-14900.550	-10.313	-870690.525439	
K56	84415.328	-14905.706	-10.312	-870490.862336	
K58	84404.156	-14910.862	-10.306	-869869.231736	
K60	84392.980	-14916.012	-8.447	-712867.502060	
K62	84385.848	-14919.309	-2.472	-208601.816256	
K63	84381.129	-14918.484	0.863	72820.914327	
K65	84380.910	-14918.446	-9.684	-817144.732440	
K47	84390.794	-14928.168	-9.586	-808970.151284	
K45	84390.818	-14928.032	4.931	416131.123558	
K46	84391.655	-14923.237	10.054	848473.699370	
K43	84403.052	-14917.978	10.325	871461.511900	
K41	84414.031	-14912.912	10.161	857730.968991	
K39	84425.075	-14907.817	10.221	862908.691575	
K37	84436.184	-14902.691	10.282	868172.843888	
K35	84447.359	-14897.535	6.346	535902.940214	
K33	84449.938	-14896.345	6.783	572823.929454	
K31	84456.850	-14890.752	10.444	882067.341400	
K30	84462.846	-14885.901	4.413	372734.539398	
				合計	1106.305351
				合計面積	553.1526755
				地積	553.15 ㎡

地番	⑭ 450-10				
NO	Xn	Yn	Yn+1-Yn-1	Xn · (Yn+1-Yn-1)	
K45	84390.818	-14928.032	13.365	1127883.282570	
K46	84391.655	-14923.237	10.054	848473.699370	
K43	84403.052	-14917.978	-8.684	-732956.103568	
K42	84409.485	-14931.921	-18.624	-1572042.248640	
K44	84399.530	-14936.602	3.889	328229.772170	
				合計	-411.598098
				合計面積	205.7990490
				地積	205.79 ㎡

地番 ⑮ 450-11				
NO	Xn	Yn	Yn+1-Yn-1	Xn · (Yn+1-Yn-1)
K43	84403.052	-14917.978	19.009	1604417.615468
K41	84414.031	-14912.912	-8.796	-742505.816676
K40	84420.427	-14926.774	-19.009	-1604747.896843
K42	84409.485	-14931.921	8.796	742465.830060
合計				-370.267991
合計面積				185.1339955
地積				185.13 m ²

地番 ⑯ 450-12				
NO	Xn	Yn	Yn+1-Yn-1	Xn · (Yn+1-Yn-1)
K41	84414.031	-14912.912	18.957	1600236.785667
K39	84425.075	-14907.817	-8.686	-733316.201450
K38	84431.433	-14921.598	-18.957	-1600566.675381
K40	84420.427	-14926.774	8.686	733275.828922
合計				-370.262242
合計面積				185.1311210
地積				185.13 m ²

地番 ⑰ 450-13				
NO	Xn	Yn	Yn+1-Yn-1	Xn · (Yn+1-Yn-1)
K39	84425.075	-14907.817	18.907	1596224.893025
K37	84436.184	-14902.691	-8.574	-723955.841616
K36	84442.504	-14916.391	-18.907	-1596554.423128
K38	84431.433	-14921.598	8.574	723915.106542
合計				-370.265177
合計面積				185.1325885
地積				185.13 m ²

地番 ⑱ 450-14				
NO	Xn	Yn	Yn+1-Yn-1	Xn · (Yn+1-Yn-1)
K37	84436.184	-14902.691	18.856	1592128.685504
K35	84447.359	-14897.535	-8.462	-714593.551858
K34	84453.642	-14911.153	-18.856	-1592457.873552
K36	84442.504	-14916.391	8.462	714552.468848
合計				-370.271058
合計面積				185.1355290
地積				185.13 m ²

地番 ㉑ 450-15				
NO	Xn	Yn	Yn+1-Yn-1	Xn · (Yn+1-Yn-1)
K35	84447.359	-14897.535	14.808	1250496.492072
K33	84449.938	-14896.345	6.783	572823.929454
K31	84456.850	-14890.752	-8.092	-683424.830200
K32	84467.922	-14904.437	-20.401	-1723230.076722
K34	84453.642	-14911.153	6.902	582899.037084
合計				-435.448312
合計面積				217.7241560
地積				217.72 m ²

地番 ㉓ 450-16				
NO	Xn	Yn	Yn+1-Yn-1	Xn · (Yn+1-Yn-1)
K31	84456.850	-14890.752	18.536	1565492.171600
K30	84462.846	-14885.901	4.413	372734.539398
K29	84467.828	-14886.339	-13.295	-1122999.773260
S9	84479.067	-14899.196	-18.098	-1528902.154566
K32	84467.922	-14904.437	8.444	713247.133368
合計				-428.083460
合計面積				214.0417300
地積				214.04 m ²

地番 ㉕ 450-17				
NO	Xn	Yn	Yn+1-Yn-1	Xn · (Yn+1-Yn-1)
K64	84371.881	-14909.409	-15.940	-1344887.783140
K63	84381.129	-14918.484	-9.900	-835373.177100
K62	84385.848	-14919.309	2.472	208601.816256
K60	84392.980	-14916.012	16.765	1414848.309700
K61	84386.765	-14902.544	6.603	557205.809295
合計				394.975011
合計面積				197.4875055
地積				197.48 m ²

地番 ㉗ 450-18				
NO	Xn	Yn	Yn+1-Yn-1	Xn · (Yn+1-Yn-1)
K60	84392.980	-14916.012	-8.318	-701980.807640
K58	84404.156	-14910.862	18.623	1571858.597188
K59	84397.939	-14897.389	8.318	702022.056602
K61	84386.765	-14902.544	-18.623	-1571534.724595
合計				365.121555
合計面積				182.5607775
地積				182.56 m ²

地番 ㉙ 450-19				
NO	Xn	Yn	Yn+1-Yn-1	Xn · (Yn+1-Yn-1)
K58	84404.156	-14910.862	-8.317	-701989.365452
K56	84415.328	-14905.706	18.627	1572404.314656
K57	84409.113	-14892.235	8.317	702030.592821
K59	84397.939	-14897.389	-18.627	-1572080.409753
合計				365.132272
合計面積				182.5661360
地積				182.56 m ²

地番 ㉛ 450-20				
NO	Xn	Yn	Yn+1-Yn-1	Xn · (Yn+1-Yn-1)
K56	84415.328	-14905.706	-8.315	-701913.452320
K54	84426.503	-14900.550	18.625	1572443.618375
K55	84420.288	-14887.081	8.315	701954.694720
K57	84409.113	-14892.235	-18.625	-1572119.729625
合計				365.131150
合計面積				182.5655750
地積				182.56 m ²

地番 ㉝ 450-21				
NO	Xn	Yn	Yn+1-Yn-1	Xn · (Yn+1-Yn-1)
K54	84426.503	-14900.550	-8.312	-701753.092936
K52	84437.679	-14895.393	18.624	1572567.333696
K53	84431.464	-14881.926	8.312	701794.328768
K55	84420.288	-14887.081	-18.624	-1572243.443712
合計				365.125816
合計面積				182.5629080
地積				182.56 m ²

地番 ㉟ 450-22				
NO	Xn	Yn	Yn+1-Yn-1	Xn · (Yn+1-Yn-1)
K52	84437.679	-14895.393	-9.286	-784088.287194
K51	84446.741	-14891.212	6.840	577615.708440
K49	84450.027	-14888.553	13.720	1158654.370440
K50	84441.078	-14877.492	6.627	559591.023906
K53	84431.464	-14881.926	-17.901	-1511407.637064
合計				365.178528
合計面積				182.5892640
地積				182.58 m ²

地番 ㉑ 450-23				
NO	Xn	Yn	Yn+1-Yn-1	Xn · (Yn+1-Yn-1)
K49	84450.027	-14888.553	-1.699	-143480.595873
K48	84461.596	-14879.191	17.323	1463128.227508
S11	84454.655	-14871.230	1.699	143488.458845
K50	84441.078	-14877.492	-17.323	-1462772.794194
合計				363.296286
合計面積				181.6481430
地積				181.64 m ²

地番 ㉓ 450-24				
NO	Xn	Yn	Yn+1-Yn-1	Xn · (Yn+1-Yn-1)
K44	84399.530	-14936.602	8.621	727608.348130
K45	84390.818	-14928.032	8.434	711752.159012
K47	84390.794	-14928.168	-8.621	-727533.035074
S14	84399.422	-14936.653	-8.434	-711824.725148
合計				2.746920
合計面積				1.3734600
地積				1.37 m ²

地番 ㉕ 450-25				
NO	Xn	Yn	Yn+1-Yn-1	Xn · (Yn+1-Yn-1)
K63	84381.129	-14918.484	-9.037	-762552.262773
K65	84380.910	-14918.446	9.025	761537.712750
S12	84371.772	-14909.459	9.037	762467.703564
K64	84371.881	-14909.409	-9.025	-761456.226025
合計				-3.072484
合計面積				1.5362420
地積				1.53 m ²

総合計面積	5556.6449080 m ²
-------	-----------------------------

地番	面積
① 153-1	498.9430110 m ²
② 153-3	225.3550740 m ²
③ 153-4	218.7039940 m ²
④ 153-5	231.1672240 m ²
⑤ 153-6	219.1337425 m ²
⑥ 153-7	189.2261300 m ²
⑦ 153-8	183.1221705 m ²
⑧ 153-9	183.1242090 m ²
⑨ 153-10	191.6107355 m ²
⑩ 153-11	170.4609150 m ²
⑪ 153-12	4.7002815 m ²
⑫ 153-13	14.9565655 m ²
⑬ 450-3	553.1526755 m ²
⑭ 450-10	205.7990490 m ²
⑮ 450-11	185.1339955 m ²
⑯ 450-12	185.1311210 m ²
⑰ 450-13	185.1325885 m ²
⑱ 450-14	185.1355290 m ²
⑲ 450-15	217.7241560 m ²
㉑ 450-16	214.0417300 m ²
㉒ 450-17	197.4875055 m ²
㉓ 450-18	182.5607775 m ²
㉔ 450-19	182.5661360 m ²
㉕ 450-20	182.5655750 m ²
㉖ 450-21	182.5629080 m ²
㉗ 450-22	182.5892640 m ²
㉘ 450-23	181.6481430 m ²
㉙ 450-24	1.3734600 m ²
㉚ 450-25	1.5362420 m ²