

地積測量図 縮尺 1:300

所在 氷見市栄町 地内

平成27年 2月13日 作成

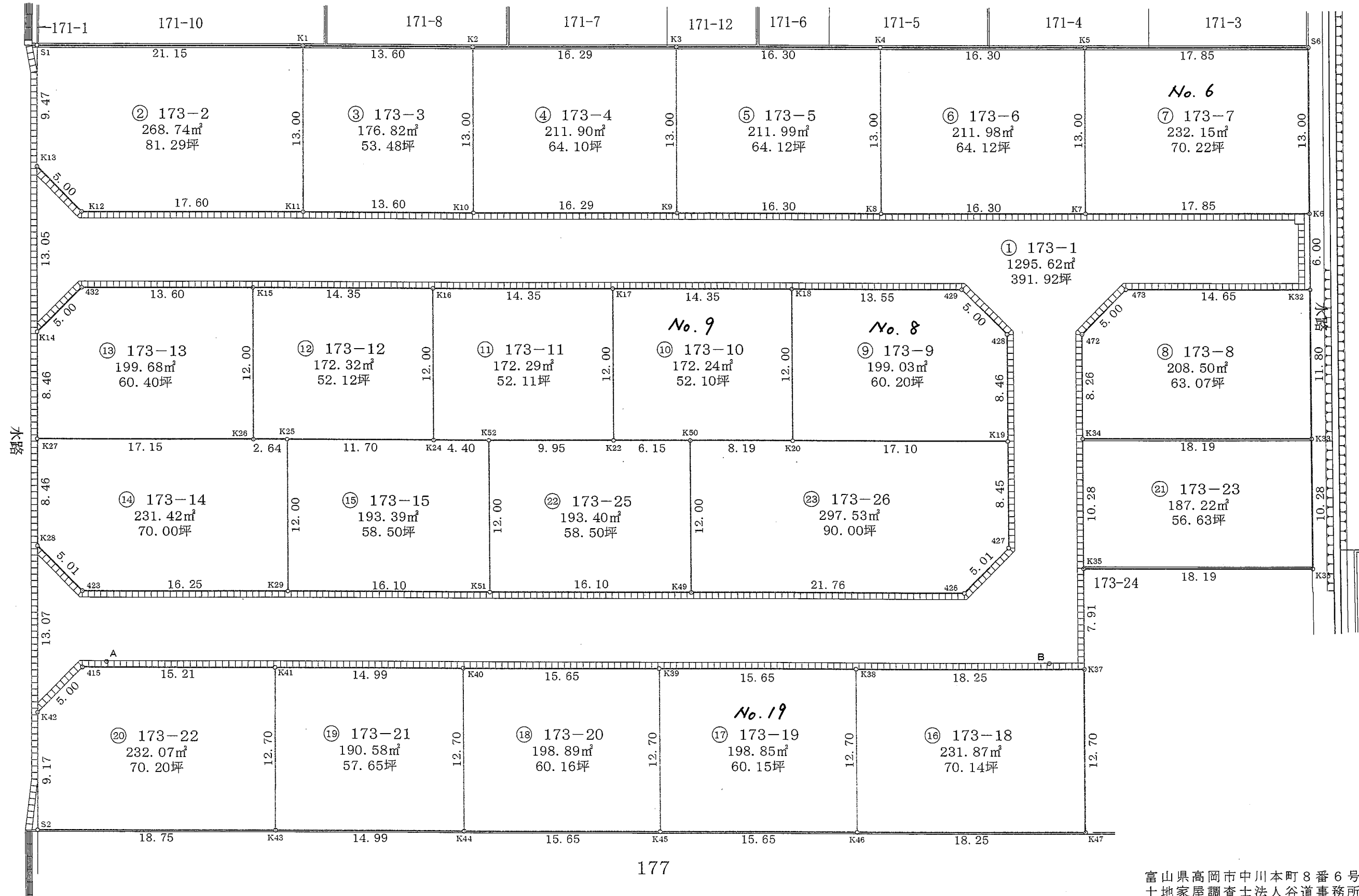
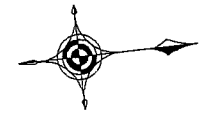

求積表

地番	① 173-1				
NO	Xn	Yn	Yn+1-Yn-1	Xn · (Yn+1-Yn-1)	
K13	506.460	484.003	-9.076	-4596.630960	
K12	509.591	487.902	5.867	2989.770397	
K11	527.090	489.870	3.486	1837.435740	
K10	540.606	491.388	3.342	1806.705252	
K9	556.801	493.212	3.639	2026.198839	
K8	573.000	495.027	3.635	2082.855000	
K7	589.199	496.847	3.812	2246.026588	
K6	606.938	498.839	7.958	4830.012604	
K32	606.269	504.805	4.321	2619.688349	
473	591.709	503.160	1.476	873.362484	
472	587.797	506.281	11.337	6663.854589	
K34	586.876	514.497	18.441	10822.580316	
K35	585.722	524.722	18.090	10595.710980	
K37	584.845	532.587	5.826	3407.306970	
K38	566.704	530.548	-3.788	-2146.674752	
K39	551.150	528.799	-3.497	-1927.371550	
K40	535.597	527.051	-3.421	-1832.277337	
K41	520.694	525.378	-3.375	-1757.342250	
415	505.576	523.676	1.424	719.940224	
K42	501.672	526.802	-9.869	-4951.000968	
K28	503.118	513.807	-9.085	-4570.827030	
423	506.251	517.717	5.730	2900.818230	
K29	522.399	519.537	3.617	1889.517183	
K51	538.404	521.334	3.594	1935.023976	
K49	554.410	523.131	4.230	2345.154300	
426	576.042	525.564	-0.711	-409.565862	
427	579.947	522.420	-11.543	-6694.328221	
K19	580.888	514.021	-16.812	-9765.889056	
428	581.836	505.608	-12.324	-7170.546864	
429	578.707	501.697	-5.425	-3139.485475	
K18	565.234	500.183	-3.112	-1759.008208	
K17	550.973	498.585	-3.207	-1766.970411	
K16	536.712	496.976	-3.208	-1721.772096	
K15	522.450	495.377	-3.116	-1627.954200	
432	508.927	493.860	1.601	814.792127	
K14	505.007	496.978	-9.857	-4977.853999	
合計				2591.254909	
合計面積				1295.627454	㎡
地積				1295.62	㎡

地番	② 173-2				
NO	Xn	Yn	Yn+1-Yn-1	Xn · (Yn+1-Yn-1)	
S1	507.520	474.591	-7.052	-3579.031040	
K1	528.544	476.951	15.279	8075.623776	
K11	527.090	489.870	10.951	5772.162590	
K12	509.591	487.902	-5.867	-2989.770397	
K13	506.460	484.003	-13.311	-6741.489060	
合計				537.495869	
合計面積				268.747934	㎡
地積				268.74	㎡

地番	③ 173-3				
NO	Xn	Yn	Yn+1-Yn-1	Xn · (Yn+1-Yn-1)	
K1	528.544	476.951	-11.401	-6025.930144	
K2	542.060	478.469	14.437	7825.720220	
K10	540.606	491.388	11.401	6163.449006	
K11	527.090	489.870	-14.437	-7609.598330	
合計				353.640752	
合計面積				176.820376	㎡
地積				176.82	㎡

地番	④ 173-4				
NO	Xn	Yn	Yn+1-Yn-1	Xn · (Yn+1-Yn-1)	
K2	542.060	478.469	-11.102	-6017.950120	
K3	558.252	480.286	14.743	8230.309236	
K9	556.801	493.212	11.102	6181.604702	
K10	540.606	491.388	-14.743	-7970.154258	
合計				423.809560	
合計面積				211.904780	㎡
地積				211.90	㎡

地番	⑤ 173-5				
NO	Xn	Yn	Yn+1-Yn-1	Xn · (Yn+1-Yn-1)	
K3	558.252	480.286	-11.107	-6200.504964	
K4	574.451	482.105	14.741	8467.982191	
K8	573.000	495.027	11.107	6364.311000	
K9	556.801	493.212	-14.741	-8207.803541	
合計				423.984686	
合計面積				211.992343	㎡
地積				211.99	㎡

地番	⑥ 173-6				
NO	Xn	Yn	Yn+1-Yn-1	Xn · (Yn+1-Yn-1)	
K4	574.451	482.105	-11.104	-6378.703904	
K5	590.651	483.923	14.742	8707.377042	
K7	589.199	496.847	11.104	6542.465696	
K8	573.000	495.027	-14.742	-8447.166000	
合計				423.972834	
合計面積				211.986417	㎡
地積				211.98	㎡

No. 6

地番	⑦ 173-7				
NO	Xn	Yn	Yn+1-Yn-1	Xn · (Yn+1-Yn-1)	
K5	590.651	483.923	-10.932	-6456.996732	
S6	608.390	485.915	14.916	9074.745240	
K6	606.938	498.839	10.932	6635.046216	
K7	589.199	496.847	-14.916	-8788.492284	
合計				464.302440	
合計面積				232.151220	㎡
地積				232.15	㎡

地番	⑧ 173-8				
NO	Xn	Yn	Yn+1-Yn-1	Xn · (Yn+1-Yn-1)	
K32	606.269	504.805	-13.373	-8107.635337	
473	591.709	503.160	1.476	873.362484	
472	587.797	506.281	11.337	6663.854589	
K34	586.876	514.497	10.252	6016.652752	
K33	604.957	516.533	-9.692	-5863.243244	
合計				-417.008756	
合計面積				208.504378	㎡
地積				208.50	㎡

No. 8

地番	⑨ 173-9				
NO	Xn	Yn	Yn+1-Yn-1	Xn · (Yn+1-Yn-1)	
428	581.836	505.608	-12.324	-7170.546864	
429	578.707	501.697	-5.425	-3139.485475	
K18	565.234	500.183	10.416	5887.477344	
K20	563.894	512.113	13.838	7803.165172	
K19	580.888	514.021	-6.505	-3778.676440	
合計				-398.066263	
合計面積				199.033131	㎡
地積				199.03	㎡

No. 9

地番	⑩ 173-10				
NO	Xn	Yn	Yn+1-Yn-1	Xn · (Yn+1-Yn-1)	
K18	565.234	500.183	-13.528	-7646.485552	
K17	550.973	498.585	10.328	5690.449144	
K22	549.633	510.511	12.613	6932.521029	
K50	555.750	511.198	1.602	890.311500	
K20	563.894	512.113	-11.015	-6211.292410	
合計				-344.496289	
合計面積				172.248144	㎡
地積				172.24	㎡

地番	⑪ 173-11				
NO	Xn	Yn	Yn+1-Yn-1	Xn · (Yn+1-Yn-1)	
K17	550.973	498.585	-13.535	-7457.419555	
K16	536.712	496.976	10.325	5541.551400	
K24	535.371	508.910	12.425	6651.984675	
K52	539.745	509.401	1.601	864.131745	
K22	549.633	510.511	-10.816	-5944.830528	
合計				-344.582263	
合計面積				172.291131	㎡
地積				172.29	㎡

地番	⑫ 173-12				
NO	Xn	Yn	Yn+1-Yn-1	Xn · (Yn+1-Yn-1)	
K16	536.712	496.976	-13.533	-7263.323496	
K15	522.450	495.377	10.332	5397.953400	
K26	521.110	507.308	12.227	6371.611970	
K25	523.740	507.604	1.602	839.031480	
K24	535.371	508.910	-10.628	-5689.922988	
合計				-344.649634	
合計面積				172.324817	㎡
地積				172.32	㎡

地番	⑬ 173-13				
NO	Xn	Yn	Yn+1-Yn-1	Xn · (Yn+1-Yn-1)	
K15	522.450	495.377	-13.448	-7025.907600	
432	508.927	493.860	1.601	814.792127	
K14	505.007	496.978	11.534	5824.750738	
K27	504.062	505.394	10.330	5206.960460	
K26	521.110	507.308	-10.017	-5219.958870	
合計				-399.363145	
合計面積				199.681572	㎡
地積				199.68	㎡

地番	⑭ 173-14				
NO	Xn	Yn	Yn+1-Yn-1	Xn · (Yn+1-Yn-1)	
K26	521.110	507.308	-2.210	-1151.653100	
K27	504.062	505.394	6.499	3275.898938	
K28	503.118	513.807	12.323	6199.923114	
423	506.251	517.717	5.730	2900.818230	
K29	522.399	519.537	-10.113	-5283.021087	
K25	523.740	507.604	-12.229	-6404.816460	
合計				-462.850365	
合計面積				231.425182	㎡
地積				231.42	㎡

地番	⑮ 173-15				
NO	Xn	Yn	Yn+1-Yn-1	Xn · (Yn+1-Yn-1)	
K52	539.745	509.401	-12.424	-6705.791880	
K24	535.371	508.910	-1.797	-962.061687	
K25	523.740	507.604	10.627	5565.784980	
K29	522.399	519.537	13.730	7172.538270	
K51	538.404	521.334	-10.136	-5457.262944	
合計				-386.793261	
合計面積				193.396630	㎡
地積				193.39	㎡

地番	⑯ 173-18				
NO	Xn	Yn	Yn+1-Yn-1	Xn · (Yn+1-Yn-1)	
K37	584.845	532.587	-14.661	-8574.412545	
K38	566.704	530.548	10.585	5998.561840	
K46	565.286	543.172	14.661	8287.658046	
K47	583.425	545.209	-10.585	-6175.553625	
合計				-463.746284	
合計面積				231.873142	㎡
地積				231.87	㎡

No. 19

地番	⑰ 173-19				
NO	Xn	Yn	Yn+1-Yn-1	Xn · (Yn+1-Yn-1)	
K38	566.704	530.548	-14.373	-8145.236592	
K39	551.150	528.799	10.879	5995.960850	
K45	549.733	541.427	14.373	7901.312409	
K46	565.286	543.172	-10.879	-6149.746394	
合計				-397.709727	
合計面積				198.854863	㎡
地積				198.85	㎡

地番	⑱ 173-20				
NO	Xn	Yn	Yn+1-Yn-1	Xn · (Yn+1-Yn-1)	
K39	551.150	528.799	-14.376	-7923.332400	
K40	535.597	527.051	10.881	5827.830957	
K44	534.179	539.680	14.376	7679.357304	
K45	549.733	541.427	-10.881	-5981.644773	
合計				-397.788912	
合計面積				198.894456	㎡
地積				198.89	㎡

地番	⑲ 173-21				
NO	Xn	Yn	Yn+1-Yn-1	Xn · (Yn+1-Yn-1)	
K40	535.597	527.051	-14.302	-7660.108294	
K41	520.694	525.378	10.9		